

Welch Allyn OAE Hearing Screener Ear Probe Instructions

Attaching Foam Ear Tips

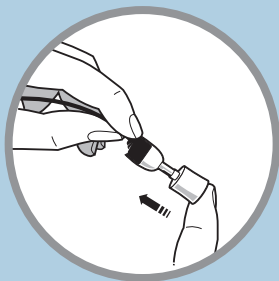

Place the clear tube slightly onto the nozzle of the probe body.

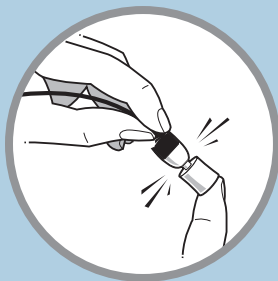

Using your fingertip, continue pushing on the top of the foam until the clear tube covers the entire nozzle.

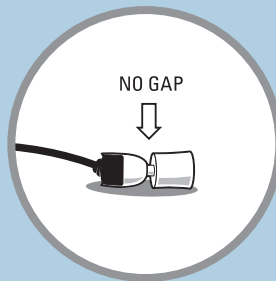

The end of the clear tube of the ear tip should cover the nozzle completely leaving no gap at the base.

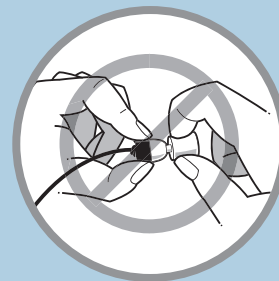

Do not pinch foam while attaching ear tip onto the nozzle.

Removal of Foam Tips

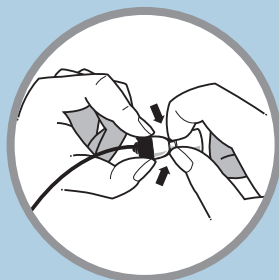

To remove foam tips, hold the probe body with your fingertips on top of the nozzle clips. Then, with the other hand, place your fingernails behind the clear tube at the base of the nozzle and slide the tube toward the end.



Do not pull on the foam. This will cause suction of the tube around grooves in the nozzle and will actually impede the removal.

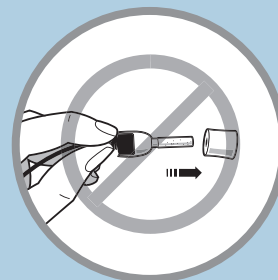

You may end up pulling the foam off of the clear tube while the tube remains on the nozzle.

Attaching Silicone Ear Tips

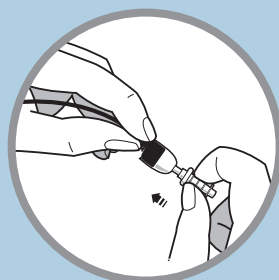

Slide ear tip onto the probe nozzle until you meet with resistance. Then place your fingernails behind the thickened ring around the base of the tip and slide the tip on until it is all the way on the nozzle.

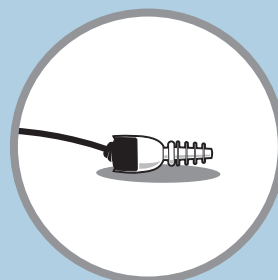

Correct Ear Tip Placement

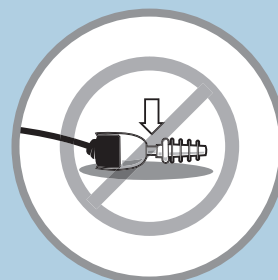

Incorrect Ear Tip Placement
(Base-end of the ear tip is not flush against base of nozzle.)

To remove the silicone ear tips, hold the probe body with your fingers on top of the nozzle clips. With the other hand, place your fingernails at the base of the ear tip and slide it off the nozzle.



Cleaning of Probe Nozzle

After removing the disposable ear tip, inspect the probe nozzle for debris in any of the three grooves.

Note: At the base of two of the grooves, a short protrusion of nylon filament may be visible. This is part of the design and should not be removed.

If debris is present, clean the grooves with a tissue or gauze pad. (A hearing aid wax removal tool may be useful for this as well if one is available.) Be sure to clean the grooves from the base to the tip to avoid pushing debris back into the closed channels at the base of the grooves. You may use an alcohol pad to clean the nozzle. Do not let excess alcohol drip down the grooves into the closed channels at the base. That portion of the probe cannot be cleaned.

Removal of Probe Nozzle

The probe nozzle should only be removed to troubleshoot data collection problems. After a few times being removed, the clips will no longer hold the nozzle securely in place on the body and the semidisposable nozzle will have to be replaced.

The nozzle has two clips that secure it to the probe body. The bottom clip is flat and smooth to the touch. The top clip has a ridge of additional plastic on its surface.

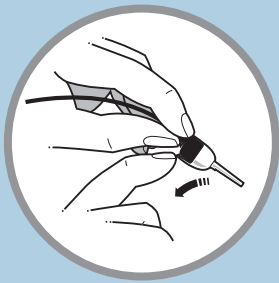

Locate the smooth, flat clip. Use your fingernail to lift up on the end of the clip to unlock it.

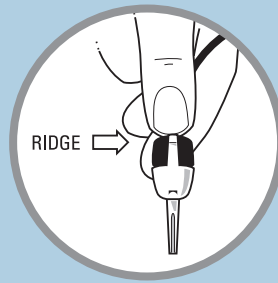

Locate the clip with the ridge and use your fingernail to lift up and unlock it.

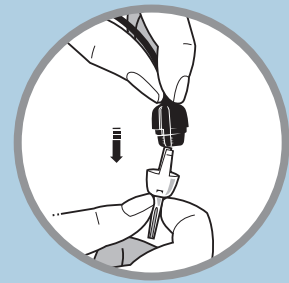

After both clips are unlocked, gently pull nozzle off of the probe body.

Installation of Replacement Probe Nozzle

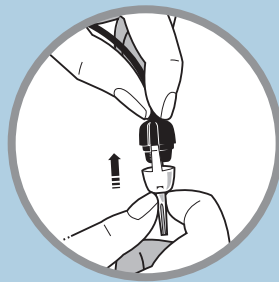

To install a new nozzle onto the probe body, align the clips on the probe nozzle with the corresponding slots in the probe body. Be sure that the probe nozzle component is oriented so that the shape of the cavity matches the shape of the probe body.

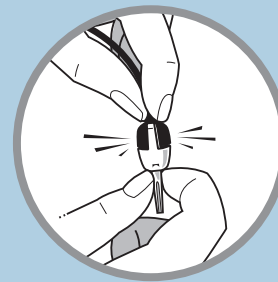

Once the two pieces are aligned to match, slide the nozzle clips down the slots until they lock into the small indentations at the back of the probe body.

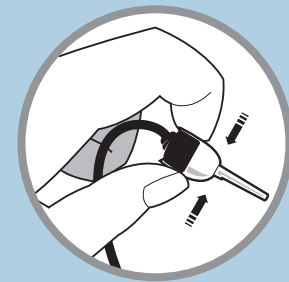

Make sure that the nozzle component is securely attached to the probe body.